

netDimmer – LED Light Remote Switch Module



Key Feature and Benefits

- Up to 30 Amp Switching control @ 480VAC
- Wireless Mesh Network control
- Dual relay option for 0/50/100% bank dimming
- Optional current sensor inputs
- Compatible with netGauges Gateways
- Optional web browser based interface
- Optional Cloud-base control
 - Time Schedule
 - Astronomical Clock (Sunrise/Sunset)
 - Daylight Harvesting
 - Partial Off states
 - Occupancy mode

netDimmer – NDRYM1 module provides remote switched control of LED drivers using a wireless mesh network and optional wireless wall switch controller or web browser based device.

Will control up to ten 250W LED lights with full power cutoff using internal relay and can operate with up to a 480 VAC supply. Switches AC power to LED driver

Mesh network allows individual wireless controllers to communicate with each switch module with ranges up to 1000 ft indoors.

Internal microcontroller provides for stand-alone operation with programable dimming profiles and external sensors. Can broadcast sensor status to central gateway for display and alerts.

When paired with a netGauges Cloud Gateway, a complete stand-alone closed loop control/monitoring system is created. For example, motion detected by a separate netGauges module can send command messages over the network to all netDimmer controllers to switch on specified zone lights.

netDimmer – Switch modules can link with other netGauges mesh controllers to implement a distributed system covering very large areas since each module relays information to all its neighbors. Thus, a motion sensor module in one location can activate lights in another area that would normally be out of detection range. With a node-to-node range of up to 4000 feet outdoors (1000 feet indoors) vast distances can be covered.

Optional Cloud base service provides status and alert emails and SMS messages based on programmed set points such as time of day or zone security. Complete data logging and reporting is available using the cloud service.

netDimmer Switch Controller will fit into standard 1-gang PVC electrical box

Specifications

- Operating Voltage: 120/480VAC; 50/60Hz
- Load Ratings: 250VAC/30A - 480VAC/5A
- Relay Life Rating: 75,000 cycles (250VAC) - 10,000 (480 VAC)
- Normal Closed or Normal Open relay options for power on bypass
- Wall Switch Controller Levels: 4 Preset Levels with separate On/Off
- Wall Switch Controller Voltage: 12VDC @ 50 mA (optional 120/480 AC Power supply)
- Wall Switch Electrical Box: Single Gang Electrical
- Mesh wireless range: 4000 feet (1200 meters) outdoors
- Mesh frequency band: IEEE 802.15.4 2.4GHZ
- Dual Relay option – 15 amps @270VAC -0%, 50%, 100% bank switching
- Optional Photocell interrupt: on/off/disabled (set point adjustable) – cloud controlled option
- Programming port: Wireless Mesh Network USB dongle (optional) or direct USB port
- Operating Temperature: -40 to 167F (-40 to 75C)
- Power Consumption: 0.5 amps
- Enclosure Environmental rating: IP64 (when installed in appropriate electrical box)
- Enclosure Dimensions: 4.6 x 2.83 x 2.3 in. / 117 x 72 x 60 mm. / 0.25 lbs

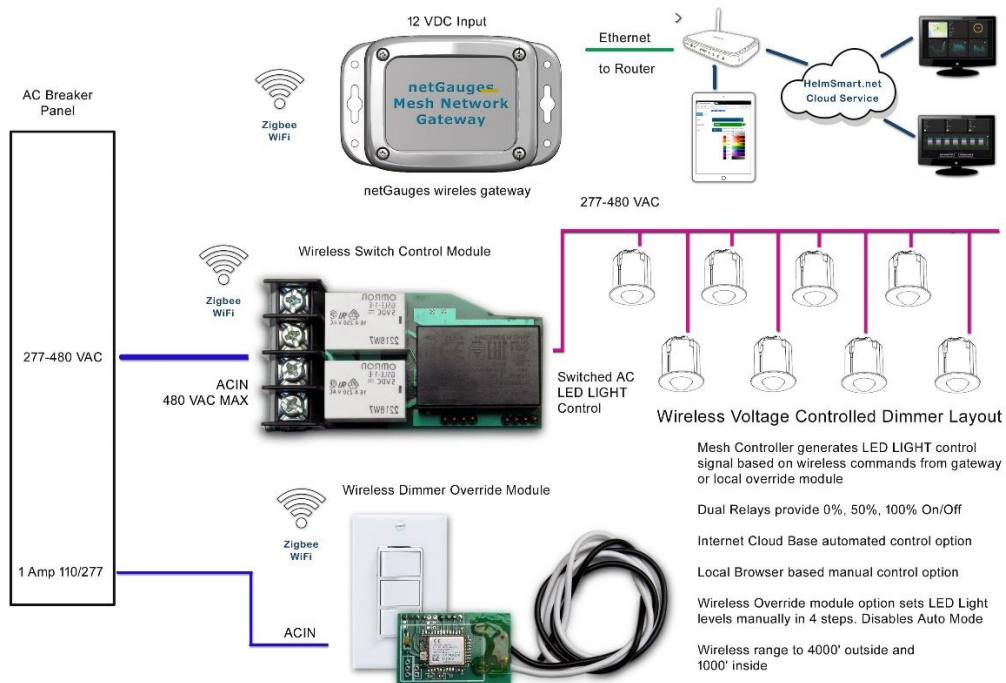

100% MADE IN USA